

RAIL 50mm x 150mm (2" x 6").

POST 150mm x 150mm (6" x 6").

FASCIA 25mm x 150mm (1" x 6").

BOARDS 25mm x 150mm (1" x 6")
OR 25mm x 200mm (1" x 8").

PRIVATE PROPERTY

PUBLIC PROPERTY

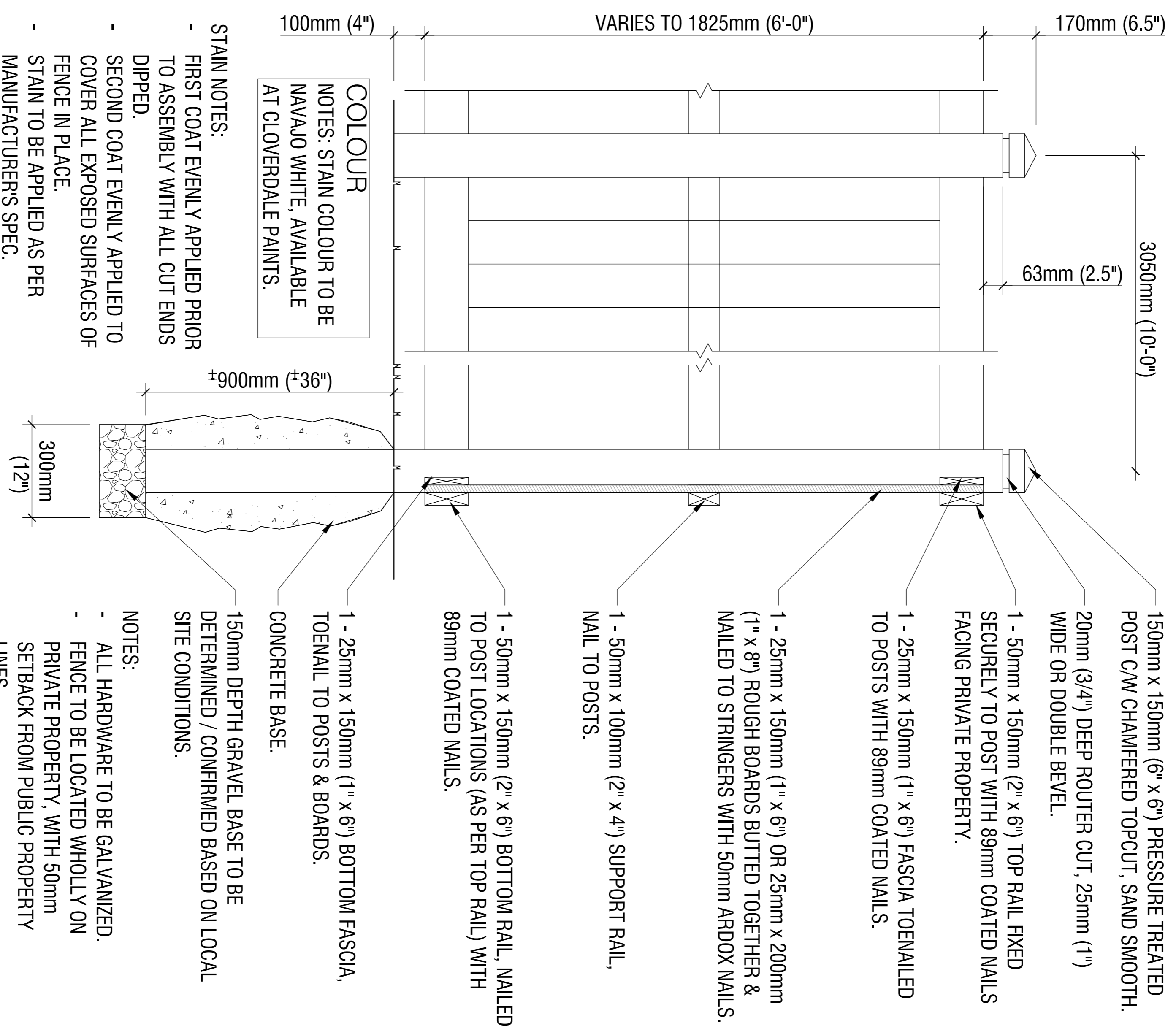

VARIES TO 1825mm (6'-0")

170mm (6.5")

3050mm (10'-0")

63mm (2.5")

150mm x 150mm (6" x 6") PRESSURE TREATED POST C/W CHAMFERED TOP CUT, SAND SMOOTH.

20mm (3/4") DEEP ROUTER CUT, 25mm (1") WIDE OR DOUBLE BEVEL.

1 - 50mm x 150mm (2" x 6") TOP RAIL FIXED SECURELY TO POST WITH 89mm COATED NAILS FACING PRIVATE PROPERTY.

1 - 25mm x 150mm (1" x 6") FASCIA TOENAILLED TO POSTS WITH 89mm COATED NAILS.

1 - 25mm x 150mm (1" x 6") OR 25mm x 200mm (1" x 8") ROUGH BOARDS BUTTED TOGETHER & NAILED TO STRINGERS WITH 50mm ARDOX NAILS.

1 - 50mm x 100mm (2" x 4") SUPPORT RAIL, NAIL TO POSTS.

1 - 50mm x 150mm (2" x 6") BOTTOM RAIL, NAILED TO POST LOCATIONS (AS PER TOP RAIL) WITH 89mm COATED NAILS.

100mm (4")

COLOUR

NOTES: STAIN COLOUR TO BE NAVAJO WHITE, AVAILABLE AT CLOVERDALE PAINTS.

STAIN NOTES:

- FIRST COAT EVENLY APPLIED PRIOR TO ASSEMBLY WITH ALL CUT ENDS DIPPED.
- SECOND COAT EVENLY APPLIED TO COVER ALL EXPOSED SURFACES OF FENCE IN PLACE.
- STAIN TO BE APPLIED AS PER MANUFACTURERS SPEC.

±900mm (±36")

300mm (12")

150mm DEPTH GRAVEL BASE TO BE DETERMINED / CONFIRMED BASED ON LOCAL SITE CONDITIONS.

CONCRETE BASE.

1 - 25mm x 150mm (1" x 6") BOTTOM FASCIA, TOENAIL TO POSTS & BOARDS.

NOTES:

- ALL HARDWARE TO BE GALVANIZED.
- FENCE TO BE LOCATED WHOLLY ON PRIVATE PROPERTY, WITH 50mm SETBACK FROM PUBLIC PROPERTY LINES.
- FASCIA IS 25mm x 150mm (1" x 6"); STRUCTURAL STRINGER IS 50mm x 150mm (2" x 6") OR 50mm x 100mm (2" x 4").

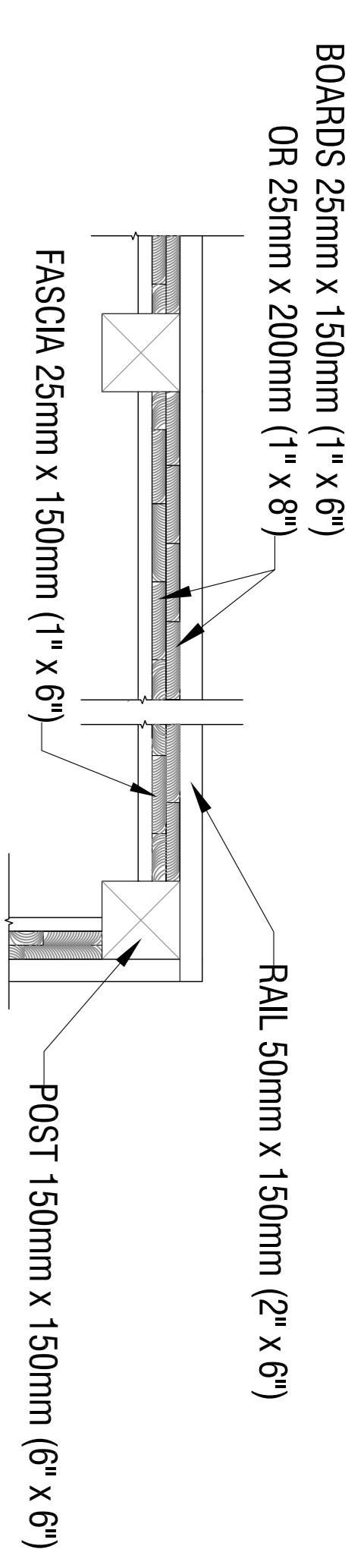

RAIL 50mm x 150mm (2" x 6").

POST 150mm x 150mm (6" x 6").

FASCIA 25mm x 150mm (1" x 6").

BOARDS 25mm x 150mm (1" x 6")
OR 25mm x 200mm (1" x 8").

PRIVATE PROPERTY

PUBLIC PROPERTY

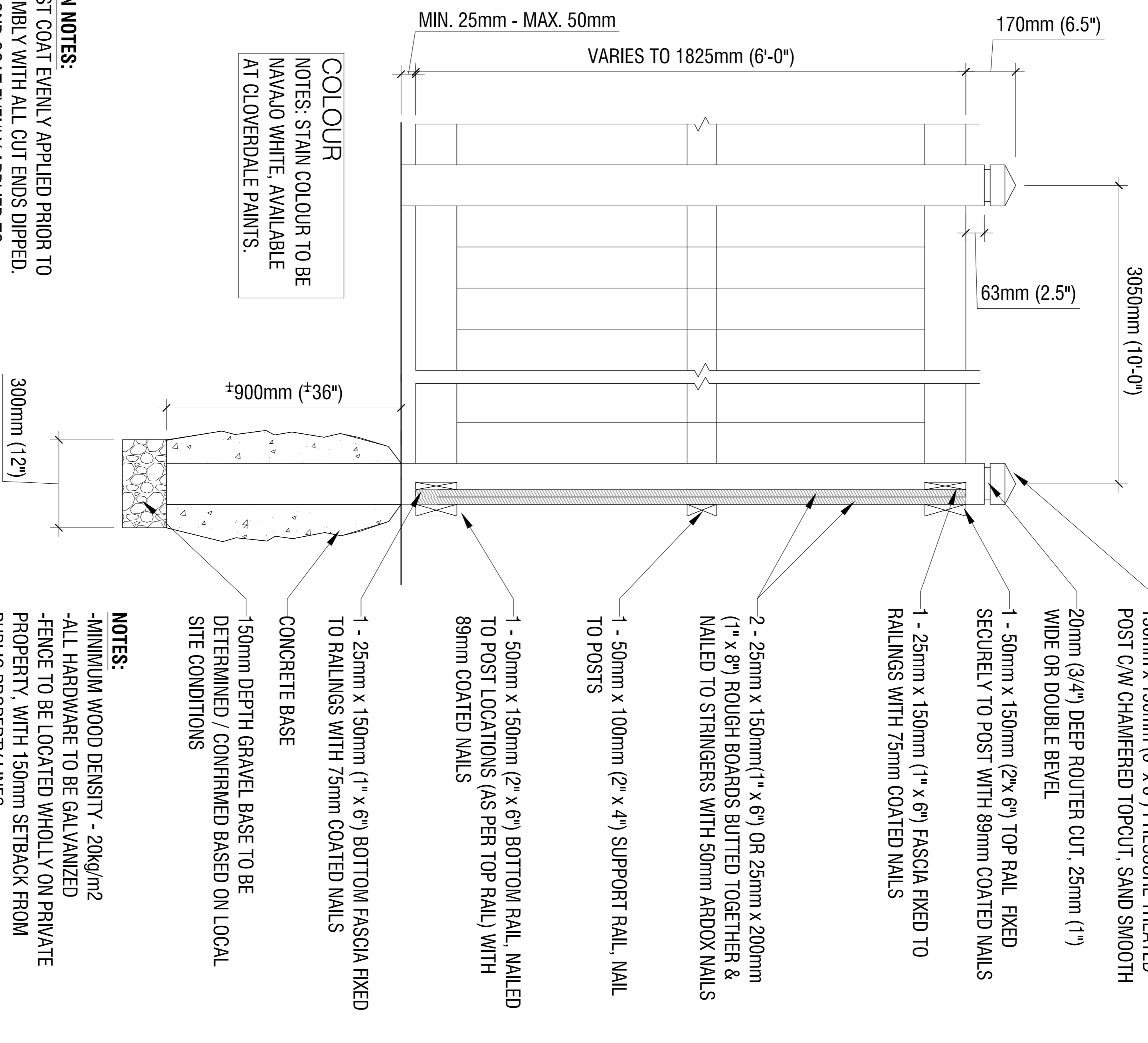

VARIES TO 1825mm (6'-0")

170mm (6.5")

3050mm (10'-0")

63mm (2.5")

150mm x 150mm (6" x 6") PRESSURE TREATED POST C/W CHAMFERED TOP CUT, SAND SMOOTH.

20mm (3/4") DEEP ROUTER CUT, 25mm (1") WIDE OR DOUBLE BEVEL.

1 - 50mm x 150mm (2" x 6") TOP RAIL FIXED SECURELY TO POST WITH 89mm COATED NAILS

1 - 25mm x 150mm (1" x 6") FASCIA FIXED TO RAILINGS WITH 75mm COATED NAILS

2 - 25mm x 150mm (1" x 6") OR 25mm x 200mm (1" x 8") ROUGH BOARDS BUTTED TOGETHER & NAILED TO STRINGERS WITH 50mm ARDOX NAILS

1 - 50mm x 100mm (2" x 4") SUPPORT RAIL, NAIL TO POSTS

1 - 50mm x 150mm (2" x 6") BOTTOM RAIL, NAILED TO POST LOCATIONS (AS PER TOP RAIL) WITH 89mm COATED NAILS

MIN. 25mm - MAX. 50mm

COLOUR

NOTES: STAIN COLOUR TO BE NAVAJO WHITE, AVAILABLE AT CLOVERDALE PAINTS.

STAIN NOTES:

- FIRST COAT EVENLY APPLIED PRIOR TO ASSEMBLY WITH ALL CUT ENDS DIPPED.
- SECOND COAT EVENLY APPLIED TO COVER ALL EXPOSED SURFACES OF FENCE IN PLACE.
- STAIN TO BE APPLIED AS PER MANUFACTURERS SPEC.

±900mm (±36")

300mm (12")

150mm DEPTH GRAVEL BASE TO BE DETERMINED / CONFIRMED BASED ON LOCAL SITE CONDITIONS.

CONCRETE BASE

1 - 25mm x 150mm (1" x 6") BOTTOM FASCIA FIXED TO RAILINGS WITH 75mm COATED NAILS

NOTES:

- MINIMUM WOOD DENSITY - 20kg/m²
- ALL HARDWARE TO BE GALVANIZED
- FENCE TO BE LOCATED WHOLLY ON PRIVATE PROPERTY, WITH 150mm SETBACK FROM PUBLIC PROPERTY LINES
- STRUCTURAL STRINGER IS (2" x 6") FOR TOP AND BOTTOM AND (2" x 4") FOR CENTER
- FASCIA IS (1" x 6")
- DECORATIVE WOOD TRIM IS (1" x 3")

1.8m HEIGHT WOOD SCREEN FENCE DETAIL

SCALE 1:20

1.8m HEIGHT DOUBLE BOARD NOISE ATTENUATION FENCE

SCALE 1:20